

EE-105

Vandal Dome Camera

❖ Winner-5
 ❖ DNR
 ❖ D/N Support



FEATURES

- Samsung Tech-win Win5 DSP Chipset
- High Resolution of 600TV Lines
- Day&Night Capability (Digital Day&Night)
- Varifocal Lens (2.8~11mm)
- IP67 rating, Aluminum Diecasting Rugged Vandal Proof Camera
- Wall or Ceiling Mounting through internal 3-Axis camera bracket
- Safety strap holds dome cover in place while making adjustments
- Excellent Auto Tracking White-Balance
- Easy operation by On Screen Display
- Extra Video out
- Electronic Image Stabilizer
- SDR Super Dynamic Range

DIMENSIONS

Unit : mm

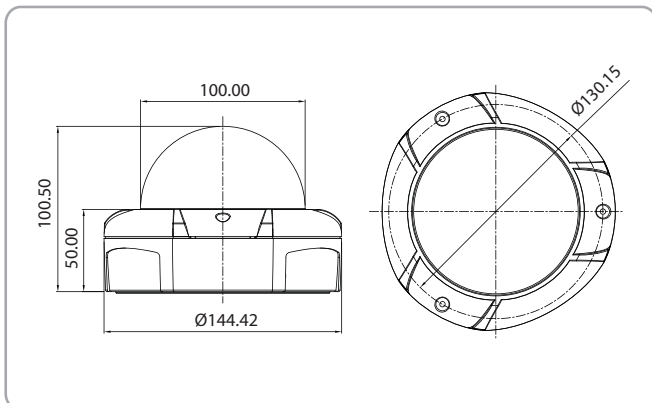

SPECIFICATIONS

| MODEL | EE-105N | EE-105P |
|------------------------|--|--|
| Image Sensor | 1/3" Sony Highly Sensitive CCD | |
| Effective Pixels | NTSC : 768 (H) x 494 (V) | PAL : 752(H) x 582 (V) |
| Scanning System | 2 : 1 Interlace | |
| Scanning Frequency | 15.734KHz , 59.94Hz (NTSC) | 15.625KHz , 50Hz(PAL) |
| Resolution | 600 TV Lines | |
| Shutter Speed | NTSC : Auto / Manual (1/60~1/120,000sec) | PAL : Auto / Manual (1/50~1/120,000sec) |
| Sens Up | ON / OFF (2x ~ 512x) | |
| S/N Ratio | 52dB (AGC off, Weight on) | |
| Sync.System | Internal / Line lock | |
| White Balance | ATW, Outdoor, Indoor, Manual, AWC (1,700°K~11,700°K) | |
| OSD | Built - in | |
| D- Zoom | On / OFF (x1 ~ x16) | |
| DNR | On / Off (2D + 3D) | |
| WDR | x | |
| Backlight Compensation | SSDR / BLC /HLC / OFF | |
| D&N | Color / Auto / B/W / EXT (Built In DC Motor Driver) | |
| PMasking | On / OFF 8 Zone | |
| Min.Illumination | 0.0003 Lux | |
| Lens | f=2.8~11mm Vari-focal | |
| Video Output | CVBS :1.0Vp-p, 75 ohm composite | |
| Power Supply | 12V DC V ± 10%. Dual Voltage ± 10% | |
| Power Consumption | 12V DC 160mA, Dual[24V AC 170mA,12V DC 250mA] | |
| Operating Temp. | -10°C ~ 50°C | |
| Operating Humidity | 30%RH ~80%RH | |

OPTIONAL MOUNT BRACKET



MB-02
 - Aluminum body
 - Unit : 1.0kg
 - Color : Cool gray / Black

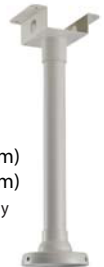

MB-03-105 (300mm)
MB-05-105 (500mm)
 - Aluminum & Steel body
 - Unit : 1.6kg
 - Color :Cool gray

CONNECTIONS

